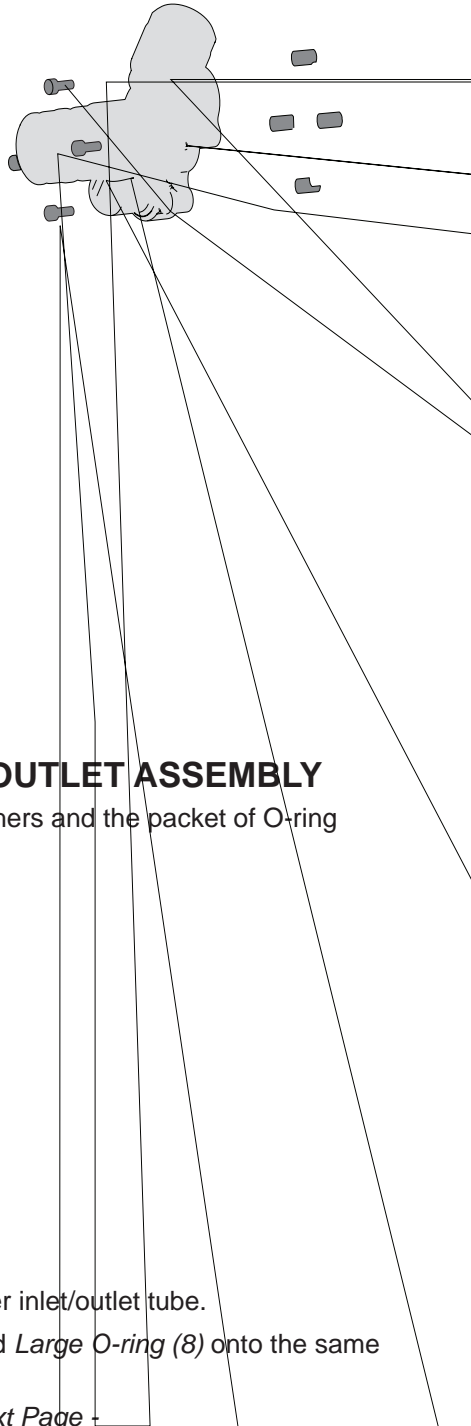

This guide provides instructions for removing and replacing the UltraTemp ETi® Gas Heat Exchanger Inlet or Outlet Assembly.

Follow these instructions to ensure proper installation of the Inlet Kit (P/N 462066) or Outlet Kit (P/N 462067).

IMPORTANT NOTICE - Attention Installer: This guide contains important information about the installation, operation and safe use of this product. This

REMOVING THE EXISTING INLET / OUTLET ASSEMBLY

1. Disconnect all power to the automatic controls at the circuit breaker.
2. Remove the service panel from the control panel side of the heater.
3. Disconnect the water line from the *Inlet/Outlet Assembly (1)*.
The top connection is the outlet and the bottom connection is the inlet.
4. Remove the four 3 mm hex-head screws securing the *Inlet/Outlet Assembly (1)* to the *Heat Exchanger (2)*. Refer to **FIGURE 1**.
5. Pull the *Inlet/Outlet Assembly (1)* away from the heat exchanger and remove it.
6. Remove the *O-rings (3)* and *Washers (4)* from each of the three *Inlet/Outlet Tubes (5)*. Refer to **FIGURE 2**.



INSTALLING THE NEW INLET / OUTLET ASSEMBLY

1. Locate the six black O-rings, three washers and the packet of O-ring lubricant provided in this kit.
Separate the four *Small O-rings (6)* and two *Small Washers (7)* from the others.
2. Apply a thin coating of lubricant to each O-ring.
Do NOT lubricate the Washers.
3. Install a *Small O-Ring (6)* onto each of the smaller inlet/outlet tubes.
4. Install a *Small Washer (7)* and a second *Small O-ring (6)* onto the same inlet/outlet tubes.
5. Install a *Large O-Ring (8)* onto the larger inlet/outlet tube.
6. Install a *Large Washer (9)* and a second *Large O-ring (8)* onto the same inlet/outlet tube.

- Continue to Next Page -

INSTALLING THE NEW INLET / OUTLET ASSEMBLY (cont.)

7. Press the *Inlet/Outlet Assembly* (10) onto the inlet/outlet tubes until it rests fat against heat exchanger.
Refer to **FIGURE 4**



1620 HAWKINS AVE., SANFORD, NC 27330 (919) 566-8000
10951 WEST LOS ANGELES AVE., MOORPARK, CA 93021 (805) 553-5000

A dca dP a ad a a d a a • • P a . T d a a d a d a d a d a d a
• • • c .
2022 P a . A d . WWW.PENTAIR.COM



P/N 476470 REV. A 10/10/22