



TABLE OF CONTENTS

INTRODUCTION

Safety Instructions 3

Installation And Operation.....4

Common Parts List

SAFETY INSTRUCTIONS

SAFETY SYMBOLS

 This is the safety alert symbol. When you see this symbol on your pump or in this manual, look for one of the following signal words and be alert to the potential for personal injury:



INSTALLATION AND OPERATION

INSTALLING PUMP IN SUMP

INSTALLATION AND OPERATION

PUMP MAINTENANCE

As the motors are oil filled, no lubrication or other maintenance is required.

If the heat sensor and seal failure are hooked up properly, no attention is necessary as long as the seal failure indicator light doesn't come on. To ensure continuity of the seal sensor leads, a test light is provided on intrinsically safe Hydromatic® panels as standard equipment. Pump should be checked every quarter for corrosion and wear.

⚠ CAUTION If cord openings from sump to control panel are open, gases from sump could enter panel and an explosive condition could exist. Seal openings!

REPLACING CORDS:

The power cord and heat sensor/seal failure cord are potted into the connection box cap, forming the cord and cap assembly.

If cords require replacement due to damage or cords being too short, cord and cap assembly must be replaced as a complete assembly from the factory. Check pump for proper rotation before returning to normal service.

COMMON PARTS LIST

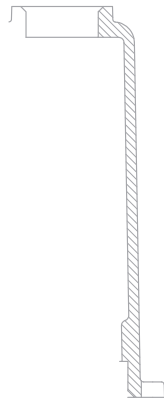

□

--

WARRANTY



AMERICAS
1101 Myers Parkway
Ashland, Ohio 44805
PH: 855-274-8947

CANADA
490 Pinebush Road,
Unit 4
Cambridge, Ontario,
Canada N1T 0A5
PH: 800-363-7867

pentair.com

All indicated Pentair trademarks and logos are property of Pentair. Third party registered and unregistered trademarks and logos are the property of their respective owners. Because we are continuously improving our products and services, Pentair reserves the right to change specifications without prior notice. Pentair is an equal opportunity employer.

MY1045 (05/15/21) © 2021 Pentair. All Rights Reserved.