

INSTALLATION AND SERVICE MANUAL
OSP50/OSP50AB
Submersible Effluent Pumps

DROMATIC®

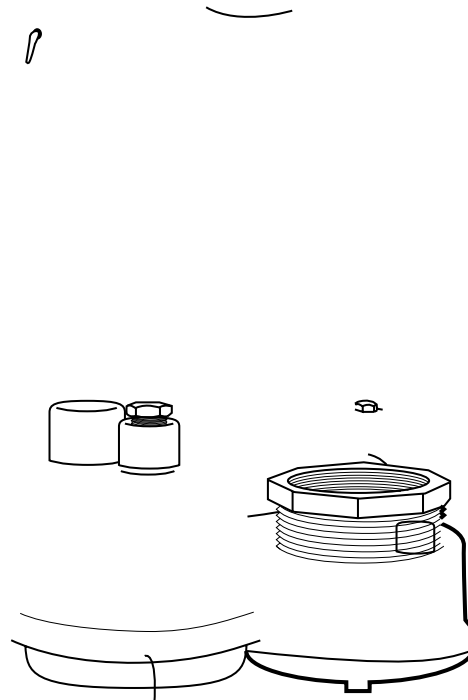

NOTE! TO THE INSTALLER: Please make sure you provide this manual to the owner of the pumping equipment or to the responsible party who maintains the system.

General Information

Thank you for purchasing your HYDROMATIC® pump. To help ensure years of trouble-free operation, please read the following manual carefully.

Before Operation:

Read the following instructions carefully. Reasonable care and safe methods should be practiced. Check local codes and requirements before installation.

Attention:

This manual contains important information for the safe use of this product. Read this manual completely before using this product and refer to it often for continued safe product use. **DO NOT THROW AWAY OR LOSE THIS MANUAL.** Keep it in a safe place so that you may refer to it often.

WARNING: Before handling these pumps and controls, always disconnect the power first. Do not smoke or use sparkable electrical devices or flames in a septic (gaseous) or possible septic sump.

California Proposition 65 Warning

▲WARNING This product and related accessories contain chemicals known to the State of California to cause cancer, birth defects or other reproductive harm.

Pump Warning

To reduce risk of electrical shock:

1. Risk of Electrical Shock:

This pump has not been investigated for use in swimming pool areas.

2. Risk of Electrical Shock:

Connect only to a properly grounded receptacle.

Septic tank is to be vented in accordance with local plumbing codes.

Do not smoke or use sparkable electrical devices or flame in a septic (gaseous) or possible septic sump.

If a septic sump condition exists and if entry into sump is necessary, then (1) provide proper safety precautions per OSHA requirements and (2) do not enter sump until these precautions are strictly adhered to.

Do not install pump in location classified as hazardous per N.E.C., ANSI/NFPA 70-2001.

Failure to heed above cautions could result in injury or death.

7. For proper automatic operation, make sure the pump power cord is plugged into the piggyback receptacle on the diaphragm switch cord.

8. Connect to separate electrical circuit taken directly from main switch.

9. Use steel or plastic pipe for all connecting lines between pump and sewer outlet.

NOTE: Some city regulations do not allow installing a pump with plastic pipe. Check local regulations.

10. In applications where the pump may sit idle for months at a time, it is recommended that the pump(s) be cycled every month to ensure the pumping system is working properly when needed.

11. HYDROMATIC check valve should be installed in discharge pipe at least 12" above the discharge outlet of the pump.

12. For greater protection, an audible alarm, such as the Hydromatic Q Alert, should be used with all pump installations to indicate a high water condition exists.

Pump Installation

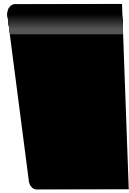

OSP50 Shown3

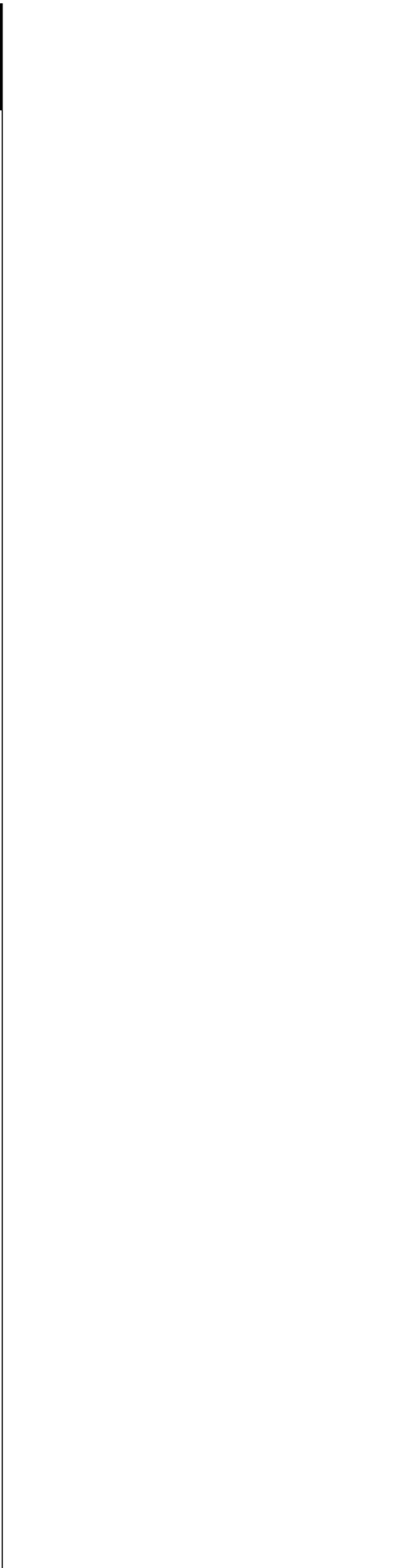

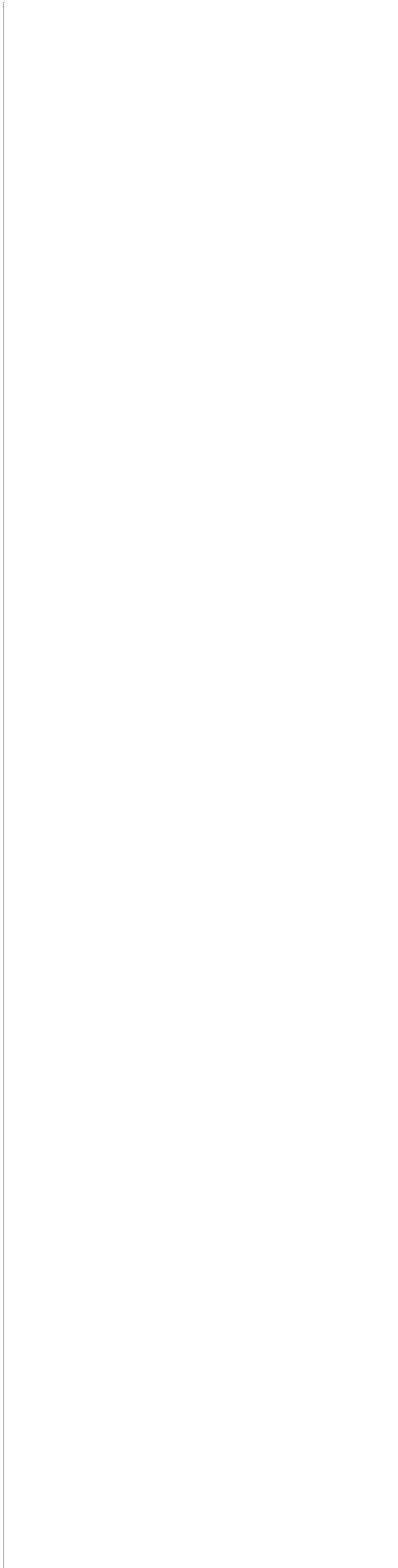

Pump Servicing

Do not fill the motor housing completely— allow airspace for oil expansion.

21. **Reinstall oil pipe plug.** Coat pipe threads with thread sealant before installing.

22. **Check pump.** Plug the power cord into a grounded outlet and start pump by applying pressure to the switch diaphragm (automatic only — manual should start when power is applied).

OSP50 Parts List

Ref. No.	Part No.	Description	Qty.
1	60-000-5	Handle	1
2	14981-001-1	Pipe Plug	1
3		Oil (Purchased locally)	.54 gal.
4	19100A012	Bolt, 5/16-18 -1/4" Lg.	4
5	14974-008-5	Diaphragm Seal (6" Range), 115V-10'	1
5	14974-009-5	Diaphragm Seal (6" Range), 115V-20'	1
5	14974-010-5	Diaphragm Seal (6" Range), 0 0 8 md8.oT2 1 Tf 85 Tm ()TjTm (5)Tj 1 1 o11F)ø Ü "€ T!Ux...i 3[€ p~A%~...Q Á ...B(-%4'HÐ F	

OSP50AB Parts List

Ref. No.	Part No.	Description	Qty.			
1	60-000-5	Handle	1	14	18-102-1	Bottom Plate
2	05022A088	Pipe Plug	1	15	12328-102-2	Volute Bz.
3		Oil	.54 gal	16	12185-001-1	Reducing Bushing
4	19100A012	Bolt 5/16 18 x 1" Lg.	4	17	77-003-1	O-Ring
5	00057-044-5	Power Cable Assembly, 115V-20'	1	18	13349-000-1	Motor, 115V
5	14974-309-5	Diaphragm Switch	1	19	56-013-2	Housing, Motor
6	30-021-1	10-32 1/2 Screw	1	20	75-007-1	Nut Cd Hex
7	5502-005-1	Switch Bracket	1	21	139-014-1	Seal Ring
8	19-004-1	Screw, 10x2 3/8" Lg.	3	22	14623-020-1	
9	14525A010	Seal	1			
10	19109A070	Jamb Nut	1			
11	33-000-2	Foot Baffle Plate Bz.	1			
12	16-000-2	Impeller Bz.	1			
13	19-002-1	Screw, 10x2 3/8" Lg.	5			

Limited Warranty

HYDROMATIC warrants to the original consumer purchaser (Purchaser or You) of HYDROMATIC Sump Pumps, Effluent Pumps, Sewage Pumps (other than 2-1/2), and Package Systems, that they will be free from defects in material and workmanship for the Warranty Period of 36 months from date of manufacture.

Our warranty will not apply to any product that, in our sole judgement, has been subject to negligence, misapplication, improper installation, or improper maintenance. Without limiting the 5(.)60(e3nten9us (.)0(antng thahe e frpserontt imwhou sg tlfprsero